



Dear Resident

BIN REPLACEMENT PROGRAMME

Glasgow City Council is investing to improve your neighbourhood and is committed to working in partnership with you to make our city a cleaner and better place to live.

From April 2020, we are replacing the small dustbins with larger wheeled bins and, where required, additional green and blue wheeled bins will also be provided. If you already have wheeled bins you may receive additional blue bins for recycling.

The benefits of the Bin Replacement Programme are significant: increasing opportunities for you to recycle; improving the containment for general waste; improving the environment of your backcourt or bin area and improving the effectiveness of your general waste and recycling collections.

Your new bin uplift frequency will move to every 8 days for general waste and every 16 days for recycling. Your refuse and recycling bins will continue to be collected from and returned to the backcourt or bin area by the refuse collection crews.

If you use on street bins for general waste or recycling, or your bins are presented on a set day, your collection frequency will not change.

An example of the new collection frequency is shown in the enclosed Frequently Asked Questions.

Recycling is a vital way of improving our environment and I want our city to waste less and recycle more. To assist you with recycling, I have provided you with a **recycling guide on the back of this letter**.

Additional information on the Bin Replacement Programme, and all council recycling services, is available on the Glasgow City Council website: www.glasgow.gov.uk/recycling.

Thank you for supporting Glasgow City Council's recycling services.

Yours faithfully

Lawrence Hay
Programme Manager
Glasgow City Council
Comhairle Baile Ghlaschu

Recycling Guide

Blue Bin

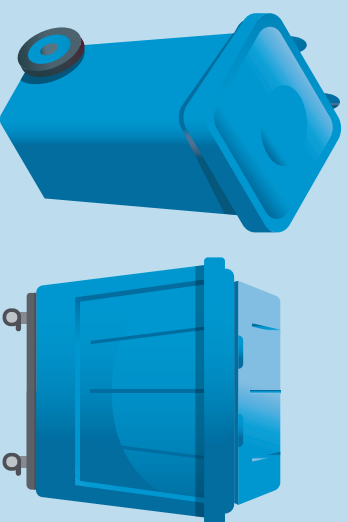

FOR DRY MIXED ITEMS ONLY



Grey Bin

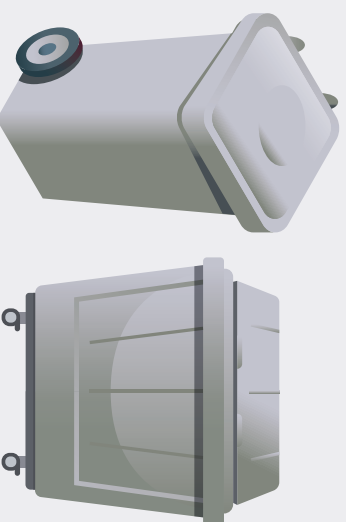

FOR FOOD WASTE ONLY



Green/Silver Bin

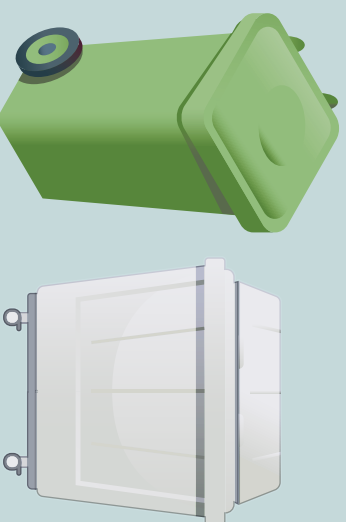

FOR GENERAL WASTE ITEMS ONLY



RECYCLING CENTRES

Clothes, textiles and electrical items/
 appliances can be taken to one of
 Glasgow City Council's Recycling
 Centres, details of locations via our
 website below.